

## MICROHAWK® ID-45

### SPECIFICATIONS AND OPTIONS



**Ultra-Compact**  
**Height:** 40.10 mm (1.58")  
**Width:** 56.70 mm (2.23")  
**Length:** 53.60 mm (2.11")

**Integrated LEDs**

**WebLink Interface Onboard**

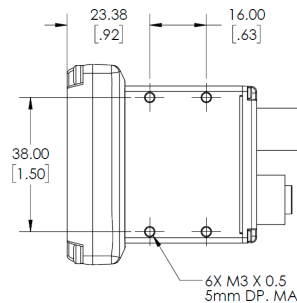
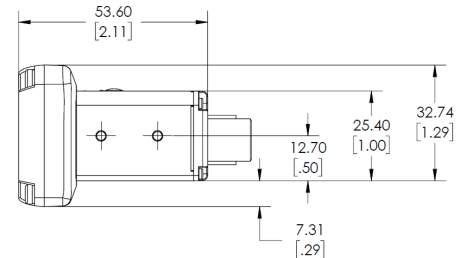
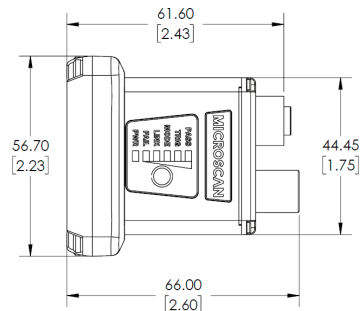
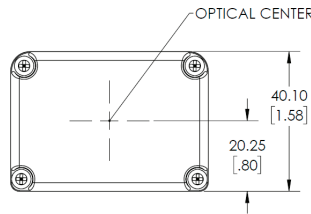

**Note:** Nominal dimensions shown. Typical tolerances apply.

#### DIMENSIONS

**Height:** 40.10 mm (1.58")  
**Width:** 56.70 mm (2.23")  
**Length:** 53.60 mm (2.11")  
**Weight:** 98.47 g (3.47 oz.)

#### ENCLOSURE

IP-65/67, Aluminum

#### ENVIRONMENTAL

**Operating Temperature:** 0° to 50° C (32° to 104° F)  
**Storage Temperature:** -50° to 75° C (-58° to 167° F)  
**Humidity:** 5% to 95% (non-condensing)

#### EMISSIONS

EN 55022:2010 Class A Limits

#### ELECTRICAL

4.75-30 VDC, 200 mV p-p max ripple, 150 mA at 24 VDC (typ.)

#### CONNECTOR

M12 12-Pin Power/I/O, M12 8-Pin Ethernet

#### COMMUNICATION

RS-232, Ethernet TCP/IP, PROFINET, EtherNet/IP™, Passive Power over Ethernet (PoE), 24V

#### DISCRETE I/O

3 in/3 out, Optoisolated Trigger Input; New Master: Bi-directional, Optoisolated, 4.5-28 V rated (10 mA @ 28 VDC); Outputs (1, 2, 3): Bi-directional, Optoisolated, 1-28 V rated ( $I_{CE} < 100$  mA at 24 VDC, current limited by user)

#### ILLUMINATION

High-Output LEDs: Inner: 4 Red, 4 White; Outer: 24 Red (624 nm)

#### INDICATORS

TRIG, PASS, FAIL, MODE, LINK, PWR LEDs; 2 Target Pattern LEDs; 2 Good Read Green Flash LEDs

#### SPEED

Standard (up to 10 FPS) or High-Speed (Max. Sensor FPS)

#### MEMORY

2 GB Non-Volatile Flash, 256 MB RAM

#### DECODER

Standard (High-Contrast 1D); Plus (High-Contrast 1D/2D); X-Mode (Poor or Damaged 1D/2D + DPM)

#### OPTICS

High-Density

#### SENSOR

SXGA (Mono) CMOS 1.2 MP (1280 x 960)

#### SHUTTER

Global (SXGA)

#### EXPOSURE

50 - 100,000, Default: 2,500  $\mu$ s

#### FOCUS

Liquid Lens Autofocus (50 - 300 mm)

#### ACQUISITION SPEED

Up to 42 FPS (SXGA)

#### SYMBOLOGIES

**2D:** Data Matrix (ECC 0-200), QR Code, Micro QR Code, Aztec Code  
**Stacked:** PDF417, MicroPDF417, GS1 Databar (Composite and Stacked)  
**Linear:** Code 39, Code 128, BC412, Interleaved 2 of 5, UPC/EAN, Codabar, Code 93, Pharmacode, PLANET, POSTNET, Japanese Postal, Australia Post, Royal Mail, Intelligent Mail, KIX

#### SAFETY AND QUALITY

FCC, CE, RoHS-Compliant

#### QMS CERTIFICATION

www.microscan.com/quality

#### CONNECTOR A: M12 12-Pin Plug

Pin	Function
1	Trigger
2	Power
3	Default
4	New Master
5	Output 1
6	Output 3
7	Ground
8	Input Common
9	Host Rx/D
10	Host Tx/D
11	Output 2
12	Output Common

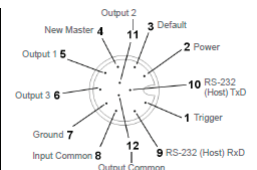

#### CONNECTOR B: M12 8-Pin Socket

Pin	Function
1*	V+
2*	V-
3*	V-
4	TX (-)
5	RX (+)
6	TX (+)
7*	V+
8	RX (-)

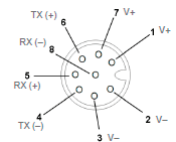

\*24V Passive PoE Only, MODE B Only

©2018 Omron Microscan Systems, Inc. SP102A-EN-0218  
 Specifications are subject to change.

For complete technical information, please see the user manual.  
 Warranty - For current warranty information about this product, please visit [www.microscan.com/warranty](http://www.microscan.com/warranty).



www.microscan.com

# MICROHAWK® ID-45 FIELD OF VIEW AND READ RANGE CHARTS

## MicroHAWK ID-45 High Density (HD) Lens

Focus Distance	Symbol Size	Inside Edge	Outside Edge
50	5.0	46	56
102	7.5	87	119
300	20.0	154	405

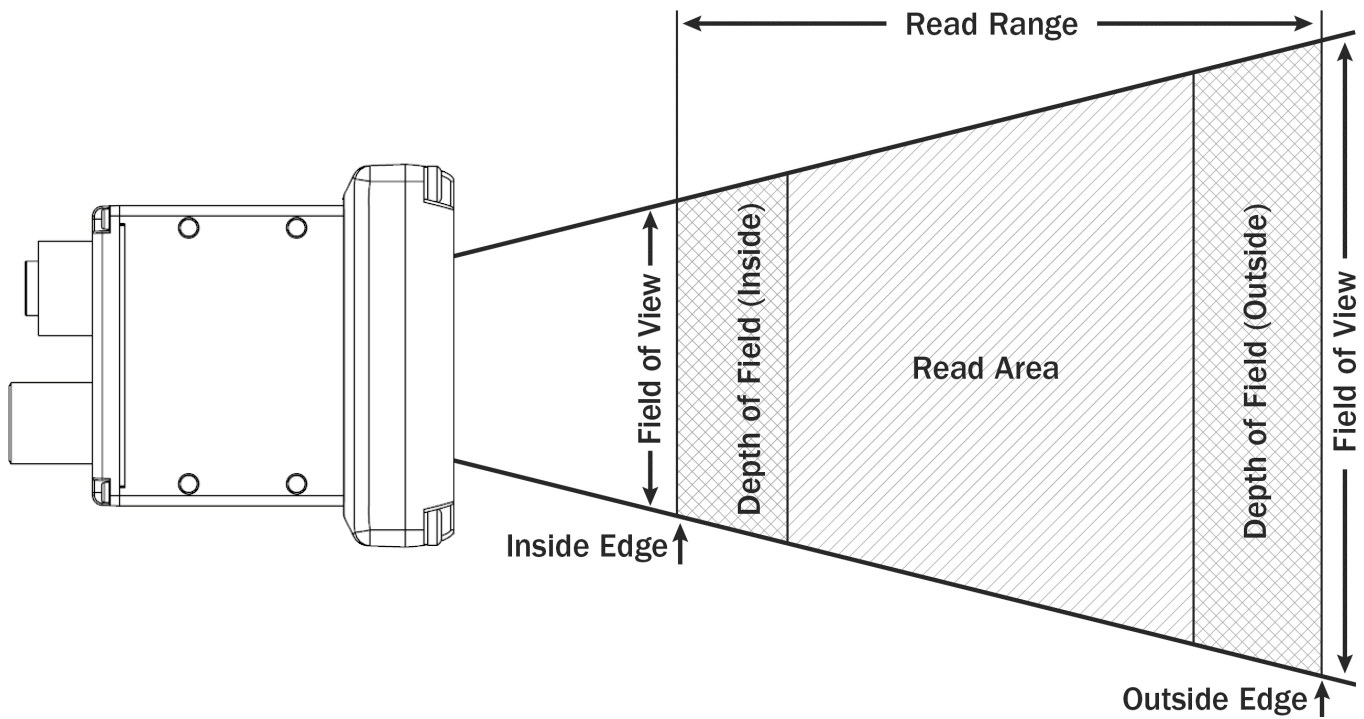

**Note:** Minimum 1D element is typically 1/2 the size of minimum 2D element. Example: 10 mil 2D = 5 mil 1D.

Specifications are subject to change. For complete technical information, please see the *MicroHAWK ID-20/ID-30/ID-40/ID-45 User Manual*, available at [www.microscan.com](http://www.microscan.com).